

GAS MONITORING

RFL200 SERIES CONTINUOUS LEVEL METER

DIGITAL TECHNOLOGY FOR OPTIMIZED MEASUREMENT

GENERAL

RF Admittance/Capacitance is by far the most versatile technologies for continuous level measurement. The RFL200 Series system can measure level of liquids, slurries, interface and granular in tanks by using special circuit to ignore material build-up on probe. There are no moving parts to wear, plug, or jam. There is only a single tank penetration, usually at the top of the tank above the actual process level. There are several sensing elements designs to handle a wide range of process conditions anywhere from cryogenics to 1000 °F and from vacuum to 10,000psi pressure. The electronic unit is loop powered. Remote models are available for high temperature or high vibration applications.



FEATURES & BENEFITS

- No Calibration Shifts
- Individual circuit to ignore material build-up
- No moving part, free of maintenance
- Simple mounting
- Intrinsically-Safe Two-Wire Design
- Rugged Construction
- Several sensing elements meet different applications
- Wide application field for liquid, slurry, granular and interface

PRIMARY AREAS APPLICATION

- Aluminum Smelters
- Asphalt Plants
- Automotive Plants
- Brewery
- Cement Plants
- Confectionary Plants
- Chemical Plants
- Coal Plants
- Coke Plants
- Fertilizer Plants
- Food Plants
- Flour Plants
- Glass Plants
- Paint Plants
- Paper Plants
- Pharmaceutical Plants
- Plastic Plants
- Power Stations
- Sewage Treatment Plants
- Soft Drink Plants
- Steel Mills
- Water Treatment Plants

SPECIFICATION

Output	4~20mA	Cable Length	Standard 10 feet, Max 150 feet
Supply Voltage	11.5 to 50 VDC at transmitter	Static Discharge	Max. 100 mps (Standard)
Ambient. Temp.	-40 to 70°F (-40 to 75 °C)	Sensor Connection	Standard 3/4"NPT, Flange Mounting Optional
Max. Load Resistance	Max. 625Ω @ 24 VDC	Electronic Housing	Meets NEMA 4X; Explosion-proof for all Groups, Div 1 & 2
Output Isolation	Min 4000V signal wire to sensor	Area Classifications	Cable and sensor are intrinsically safe for all Groups, Div.1&2. Electronic are FM approved intrinsically safe for Class I, II, III, Div.1, Groups C, D, E, F, G. Explosion-proof for Class I, Div. 1, Groups A, B, C, D (remote mount only). Dust ignition-proof for Class II, Div.1, Groups E, F, G. Also, suitable for Class III, Div.1 Non-incentive for Class I, Div.2 Groups A, B, C, D.
Response Time	Approx. 0.2 s Adjustable 0.5 to 30 s (Optional)		
Supply Voltage Error	0.2% of		
Accuracy	±1% Normal		
Load Regulation	0.2% for Zero to max. load resistance		

Sensor	Process Pressure & Temperature	Std. mtg.	O.D. & Wet Material	Max. I.L.	Application
S01	500 psi(34.5 BAR) @ 300°F(149°C) 1000 psi(69 BAR) @ 100°F(38°C)	3/4" NPT	0.56" O.D. 316 SS & FEP (bonded)	19 ft	Corrosive liquids
S03	1000 psi(69 BAR) @ 100°F(38°C) 500 psi(34.5 BAR) @ 450°F(232°C)	3/4" NPT	3/4" O.D. 316 SS & TFE	14ft	Heavy duty, high temperature liquid or slurry
S04	500 psi(34.5 BAR) @ 300°F(149°C) 1000 psi(69 BAR) @ 100°F(38°C)	3/4" NPT	3/8" O.D. 316ss & TFE	20ft	Common service liquid or light slurries.
S05	500 psi(34.5 BAR) @ 300°F(149°C)	3/4" NPT	0.093" O.D. 316ss & PFA(bonded)	3000ft	Flexible cables S.E. for deep well. Remote only
S06	500 psi(34.5 BAR) @ 300°F(149°C) 1000 psi(69 BAR) @ 100°F(38°C)	1-1/2" NPT	3/8" O.D. SE, 1.66" O.D. shield, 316ss & TFE	20ft	Insulating liquid, typical for oil
S07	0 psi(0 BAR) @ 450°F(232°C)	1" NPT	3/16" O.D. 316 SS	200ft	Insulating liquid, slurry or granular
S08	500 psi(34.5 BAR) @ 300°F(149°C) 1000 psi(69 BAR) @ 100°F(38°C)	3/4" NPT	0.093" O.D. 316ss & PFA (bonded)	400ft	Flexible cables S.E. for liquid or light slurries
S10	200 psi(14 BAR) @ 450°F(232°C)	3/4" NPT	3/8" O.D. 316ss & TFE	6ft	Three terminal S.E. for insulating liquid or slurries
S12	500 psi(34.5 BAR) @ 450°F(232°C)	1" NPT	3/4" O.D. 316 SS & TFE	14ft	For desalter continuous interface. Remote only

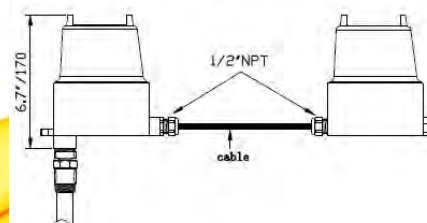
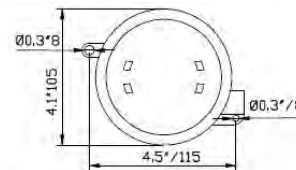
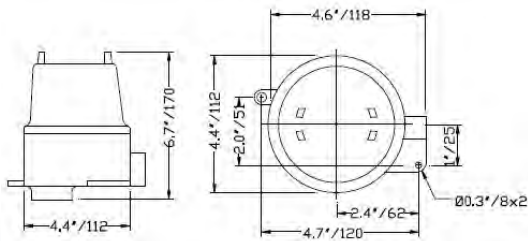

DELTA-PHASE ELECTRONICS, INC.
3 Peters Canyon Rd, Suite 100.,
Irvine, CA 92606 U.S.A.
Phone: (949) 701-7728
<http://www.delta-phase.us>